



OAKFIELD



St. James Road, Bexhill-On-Sea, TN40 2DF

£885 Per Calendar Month



St. James Road, Bexhill-On-Sea, TN40 2DF

This one double bedroom ground floor flat is perfectly situated within walking distance to local shops in Sidley high street. The property is also only a bus journey away from the Bexhill Town Centre, Ravenside Retail Park and practices such as Sidley Surgery and a Dentist.

As you enter the property through it's private entrance you're greeted into a spacious living room. Proceeding through the property is a modern fitted kitchen with oven and hob, a modern fitted bathroom with large bath and shower over and a double bedroom with large window overlooking the garden. Just off the kitchen is access to a private rear courtyard garden. All of the external walls in the living room and bedroom have been internally insulated, there are three low costs infra-red heating panels in the living spaces which makes the flat energy efficient.

Further benefits to the property include gas central heating, double glazing throughout and street parking.

Please note:

An annual household income of £26,550 will be required for the affordability criteria of this property.

The minimum tenancy length is 12 months.





Lounge

17'7 x 11'9 (5.36m x 3.58m)

Kitchen

11'4 x 6'0 (3.45m x 1.83m)

Bedroom

11'6 x 8'5 (3.51m x 2.57m)

Bathroom

7'1 x 5'10 (2.16m x 1.78m)

Council Tax Band A - £1,701.55 per annum



Floor Plan

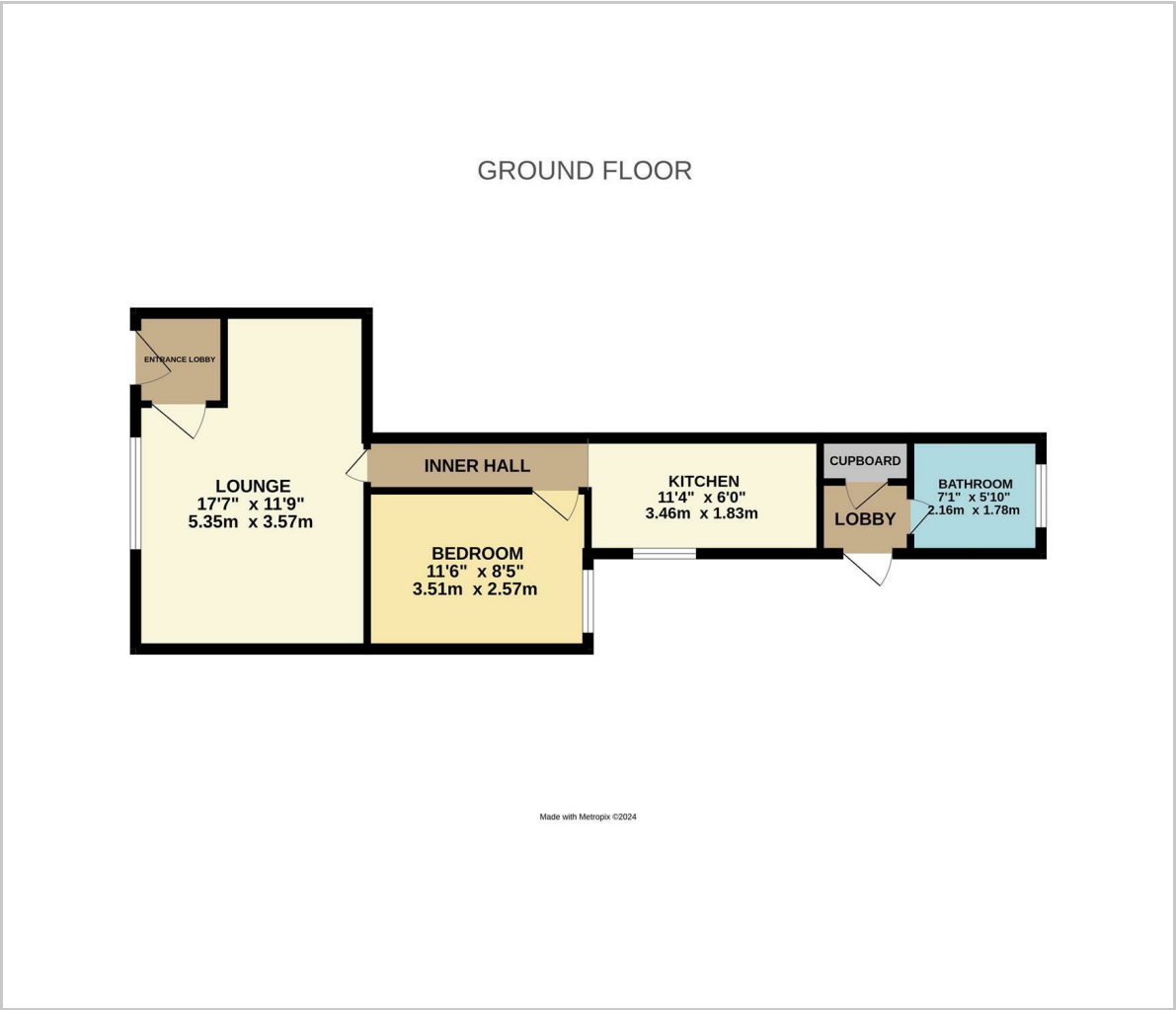

Viewing

Please contact us on 01424 817075 if you wish to arrange a viewing appointment for this property or require further information.

These particulars, whilst believed to be accurate are set out as a general outline only for guidance and do not constitute any part of an offer or contract. Intending purchasers should not rely on them as statements of representation of fact, but must satisfy themselves by inspection or otherwise as to their accuracy. No person in this firms employment has the authority to make or give any representation or warranty in respect of the property.

Area Map

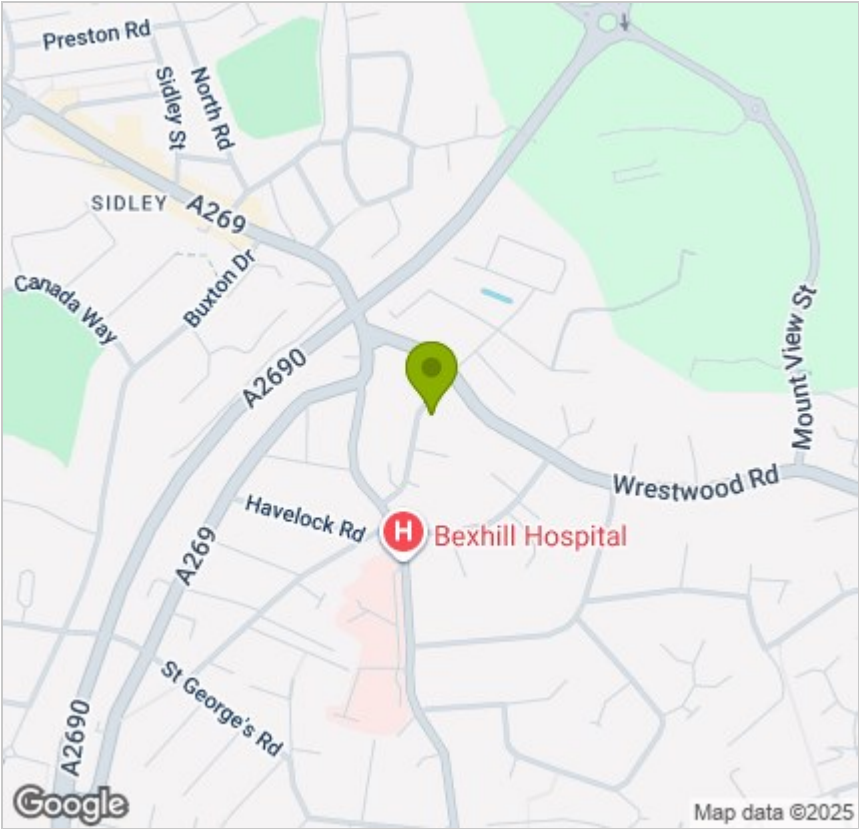

Energy Efficiency Graph

